

# INVESTIGATION REPORT



**Investigation Site** Luton, Wilsden Avenue

**Investigation Date** 12<sup>th</sup> November 2005

**Report By** Bill King

**Team Members** Teams varied during investigation. See individual vigils for details.

## Pre-Vigils

Additional information provided at the start of the investigation.

- The ball from the tracking device used on Kath's computer has gone missing. This is a large ball about 60mm across.
- Recently keys have been placed on the coffee table and they would be found moved elsewhere. Now keys are kept in the kitchen and this no longer occurs. The kitchen was chosen as nothing happens in that room.
- John used to wear a bracelet and ring (bought as a celebration of their marriage) but these have now gone missing. He does not wear them for work due to the nature of his work so they must have gone missing from within the house.
- A couple of years ago dark staining appeared on the living room wall. This lasted for several days and was in the form of rivulets as if something was flowing down the wall. When redecorated it took several coats of paint to cover the marks. Staining was to the right of where the chimney stands (fireplace has been removed and area covered over). No sign of corresponding staining in the master bedroom.

## Vigil 1: Master Bedroom

Team: Karl and Marion

21:15 Karl reports having a bad headache and feeling restless. He experienced the sensation of a running or bleeding nose. Had a feeling of losing an item. Feeling tired but just in the main bedroom

21:30 Nose or throat

22:00 Karl reported that he didn't feel comfortable around the doll and pram. Karl also felt that he had a very painful left eye. He received the impression of a young man and a grandmother. Also a sense of itching and scabs. Doll is a problem.

22:34 Standing in front of TV Karl saw some sort of light to his left. Picked up on the name Sam or Samuel. Impression of cutting meat.

## Vigil 2: Master Bedroom

Team: Bill, Leana, Andy

23:35 Vigil starts

23:38 As Bill sat down on the floor he heard a distinct creak from the area of the right-hand bedside cabinet/wardrobe. This occurred several seconds after he was in place (see general room plan).

23:40 Leana feels that the room is imposing. She does not like a doll on the cabinet at all. She gets a negative feeling from it. The doll on the floor looks worse but she does not feel anything from it just the one on the cabinet.

# INVESTIGATION REPORT



**Investigation Site** Luton, Wilsden Avenue

**Investigation Date** 12th November 2005

Generally Leana doesn't like dolls but she doesn't feel that that is why she doesn't like the doll on the cabinet (after all she has no negative feelings towards the one on the floor).

23:42 Leana does not like the wardrobe, she does not even like to look at it.

23:45 Temperature 15.5°C to 16.5°C, 13.5°C on the wall by the window.

23:50 Leana reports that her hands feel cold. Measured 24.5°C compared to Andy at 31.5°C and Bill at 34.5°C.

23:53 Leana reports that her right arm feels numb.

23:56 Leana reports that she feels better.

23:57 Andy stands by second door from the left of the wardrobe with his right side towards the window. Reports that he feels goose bumps down his right-hand side. He said that on Monday he felt 'unnatural', like icy cold.

00:01 Measurements of hand temperatures reveal that Leana's are now at +29°C, Andy 30.5°C, Bill 34°C.

00:06 Bill saw a bright spot in the bottom left corner of the wardrobe (near the cabinet) and about 20cm above the floor. At the time Andy was standing by the second wardrobe door from the left. Bill also saw a bright streak a few centimetres from Andy's right knee and reaching from his knee almost to the floor.

00:11 Leana says that she is feeling sick.

00:12 Bill reports seeing a bright blob on the wall 50 cm to the right of the light switch and 20cm below.

00:16 Leana reports that her left knee feels cold but not her right.

00:20 Leana measured her left knee temperature at 20°C, right knee 23, top of right leg 28°C, top of left leg 24.5°C. At the time she was wearing a long dress that reached to the floor and her legs were covered.

00:29 Leana reports a distinct smell of citrus, lemons and oranges.

00:35 During the investigation Bill, who was sitting on the floor by the window, left cold on his right-hand side, at the time he put it down to a draft from the window. At the end of the investigation

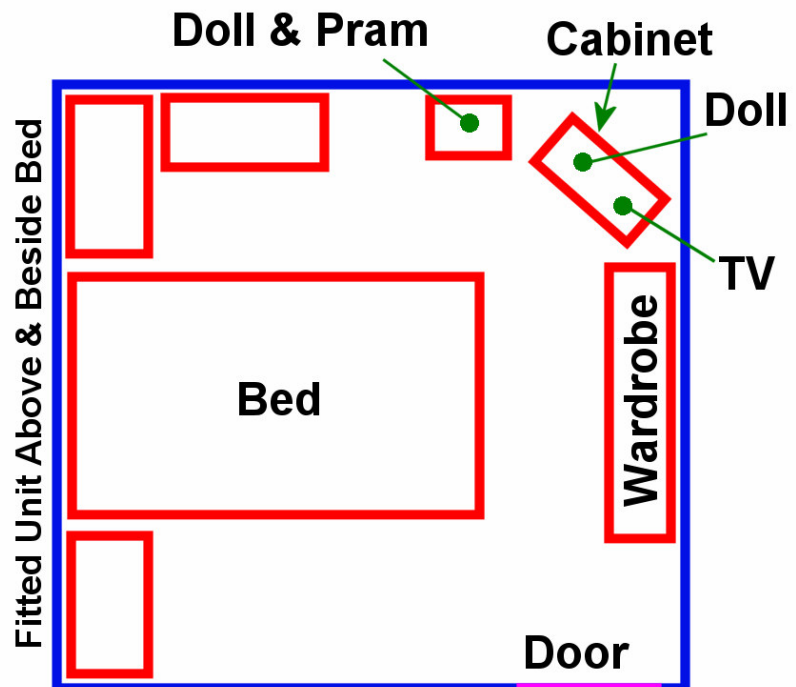

# INVESTIGATION REPORT



**Investigation Site** Luton, Wilsden Avenue

**Investigation Date** 12th November 2005

Leana stood in the same area and said that she felt cold on her left-hand side irrespective of which way she faced.

## Post-Investigation

Leana reported that during Vigil 2 her left knee went cold, several degrees below her other knee. In a split second it had warmed up to the point of being hotter than her right knee. She found that she was shaking uncontrollably which she had also done just before going upstairs with Team 2. She also saw shadows moving across the wardrobe. She got the feeling that something was not just standing in front of the wardrobe but that it was coming out of it from the middle. She did not know what it was.

Two days ago Karl felt something that didn't want him to be there, he felt nauseous and as if something was strangling him. He felt as if some entity was feeding off fear. Tonight he felt that there was a new spirit person that doesn't want to be known, it was raising a barrier. He sensed a 16 year old boy who wanted to make mischief, he would pinch you and laugh and he moves things. He wants to hurt people but didn't do anything to Karl and Marion as they are not scared of him. Karl sensed he was a scrawny lad from Birmingham who worked on a barge; he also had the impression of coal. Karl asked him why he was nasty and was told that his father had been nasty to him so he wanted revenge. He wouldn't say how he got there (Wilsden Avenue). As a modern analogy Karl compared him to a hoodie. Now he says he is bored, he knows he is on his way. Karl feels as if someone has opened a door and let him in. Karl intends to try to close the door. Marion came up with the name Ellis and said they were related to Kath. Karl gave the name Samuel. In fact Kath and John report that a previous owner had used the living room as a bedroom and that he died in the room. This was 6 months before Kath and John bought the house. The previous owners were Rebecca and Samuel Shelton. Samuel was born on 8th April 1910 and died in April of 1985. John says that the Sheltons were a family of haberdashers. Sam actually tried to possess Karl. Karl reported that he was wearing a mask, trying to hide who he is. Karl says he is also cheeky. Kath has also felt that this spirit was hiding itself.

Karl felt that the spirit on the stairs is a childish adult and it is he who turns on the smoke alarms. He was not present when we were there as he knows what is going on.

Previously Karl got the impression of animal carcasses and butchery (investigation has shown that the house stands almost exactly where the out-buildings of Farley Farm stood before the houses were built). Karl also said that someone had lost a ball. Kath had lost the ball from her trackball after our first visit. Karl said that he felt a cat had got it.

In the master bedroom Karl felt there was a woman, a grandmother, standing near the chest of drawers. He feels she was the headmistress type, strict and upright.

Karl was unaware that Kath owned a Parrott when he reported that Sam hated the Parrott, he could not understand the relevance of this until he was told about Kath's pet. Karl asked Sam if he had killed Kath's previous Parrott (see initial report). Kath's Parrott had been perfectly healthy one day and dead two days later. The Parrott that died was called Bob, the new Parrott keeps saying 'hello Bob' which is something he has never been taught.

Karl then proceeded to cleanse the house upstairs and downstairs including the cupboard under the stairs.

# INVESTIGATION REPORT



**Investigation Site** Luton, Wilsden Avenue

**Investigation Date** 12th November 2005

## Anomalies Observed on Main Bedroom Monitor

22:25 Orb on TV screen going downwards.	23:28 Another orb.
22:28 Orb floating downwards.	23:30 Team 2 gone upstairs.
22:29 Orb across screen.	23:35 Orbs all around Leana.
22:30 Orb.	23:37 Top left-hand corner.
22:35 Orbs all over screen in room.	23:37 Top to bottom, centre.
22:40 Orb above Karl.	23:37 Top around Leana.
22:41 Orb on chest of drawers.	23:37 Chest of drawers, Leana pointing at this orb.
22:43 Orb across screen.	23:40 Top left-hand corner.
22:44 Two orbs down screen.	23:43 Leana's head.
22:45 Orb above Karl.	00:15 Orb top right, down and sideways.
22:46 Orb across screen.	00:15 Two orbs across, slanting.
22:46 Flash above Marion.	00:15 Big one in front of window.
22:51 Orb floating.	00:17 Shadow in front of window.
22:56 Orb.	00:20 Orb top to bottom.
22:59 Orb top of screen.	00:25 Down towards Leana while her hand was up.
23:03 Orb down left of screen.	00:26 Left to top.
23:10 Orb top of screen.	00:27 Top of screen.
23:13 Orb across screen.	00:28 Top middle to bottom.
23:15 Camera is moving x3.	00:30 In front of chest of drawers.
23:16 Camera is moving.	00:30 Shadow in front of curtain, left to right.
23:20 Camera is moving.	00:32 Leana standing up, two then one from her.
2320 Black shadow across window.	00:37 Team leaves room.
23:21 Orb across and moving, lot of activity.	00:55 Light flash above Leana's head.
23:22 Movement, lots.	01:00 Orb down screen.
23:23 Movement, lots.	01:10 Orb.
23:23 Orb.	01:20 Something across wardrobe.
23:25 Orb across TV.	01:20 Orbs
23:27 Orb across screen.	
23:27 Large orb up.	

# INVESTIGATION REPORT



**Investigation Site** Luton, Wilsden Avenue

**Investigation Date** 12th November 2005

## Former Residents of Wilsden Avenue

1950	William H. Carlton Joyce W. V. Mann Richard W. Mann Agnes E. Mann	1965	as 1962 +Three Star Radio Taxis
1952	as 1950 +Ellen V. Carlton	1966	Rebecca Shelton Samuel Shelton Stephen Shelton
1953	as 1952	1967	Rebecca Shelton Samuel Shelton
1954	William H. Carlton Ellen V. Carlton Richard W. Mann Agnes E Mann	1969	Rebecca Shelton Samuel Shelton Alan M. Shelton
1955	As 1954 -Richard W Mann	1970	as 1969 +Evelyn Shelton
1956	as 1955 +Arthur Kaye +Dorothy F. Kaye	1971	as 1970
1957-59	William H. Carlton Ellen V. Carlton David A. Langford M. D. Lond. Hella M. Langford	1972	Rebecca Shelton Samuel Shelton
1961	Jessica M. Doherty Samuel C. Doherty	1973	Samuel Shelton Evelyn A. Shelton
1962	Mary M. Moore Robert S. Moore	1974-78	Betty Shelton Samuel Shelton
1963	as 1962 +S. Dudley	1979	Page missing from register
1964	as 1962	1980-85	as 1972 Samuel Shelton, b. 8th April 1910 d. April 1985
		1986	Rebecca Shelton
		1987	No entry
		1988	John E. Berry Kathleen J. Berry