

INVESTIGATION REPORT – Team 3



Investigation Site	Luton, Wardown Park Museum
Investigation Date	28 th September 2007
Report By	Bill King
Team Members	Bill, Leana

Pre-Investigation

Before the investigation, Andy, Steph, Elaine and I (Bill) visited the museum to aid us in planning the event. This took place on Saturday 15th September and included a tour of the building including the cellars. During the tour I had my EMF meter turned on in my pocket and it remained silent (detected fields <10mG) until one particular area where it suddenly went off. This area was found to occupy a strip about 2m long and 1m wide at the western end of the long corridor on the first floor (marked '✱' on the plans at the end of this report). The area had two peaks in the reading with a dip in-between as you walked along the line marked by the arrow on the drawing.

Pre-Vigils

On the day of the investigation I asked Leana to go for a walk-around to see if she could pick up on anything. I gave her the EMF meter and asked her to check everywhere but especially the area where the high readings had been noted. When she returned she said that the meter had hardly changed everywhere else but did give a high reading in the appropriate area. Testing of the area later in the evening (22:10) revealed no readings in this area. At that time the lights were off so could it have been the lights in the corridor below? If that was the case then why did the meter only go off in one place as the lights run for around eight meters down the corridor below with a similar corridor above? Walking the line above the downstairs corridor gave no other readings.

Post-Investigation

Checking the area again on a different day, 3rd October, gave the same EMF readings so it seems likely that there is something in that area when the museum lights etc. are on. The most likely cause is the overhead spot lights though why these should affect the EMF meter and other, similar ones, do not is unknown.

Ouija: Lace Gallery, Stairs and Regiment Gallery

Before this session started I left a video recorder in the cellar facing along the corridor where bodies were supposed to have been left when the building was used as a hospital. This camera has no night-vision facility so the lights were left on during the 1.5 hour recording. Video camera positions are marked on the plans at the end of this report by the symbol  where the arrow indicates the direction the camera was facing.

Before we started the vigils we went to the Lace Gallery to use the Ouija board. Unfortunately nothing happened but at around 18:54 both Steph and Elaine reported that they had heard someone walking past the stairs. At the time all of the people involved in the investigation were in the Lace Gallery with Elaine closest to the door into the corridor which leads to the stairs.

During this experiment I set my night vision camera up just inside the door of the Lace Gallery facing towards the glass display case opposite the door. This was done as it had been reported that someone had seen a woman's reflection in the glass when there was no one else in the room.

INVESTIGATION REPORT – Team 3



Investigation Site Luton, Wardown Park Museum

Investigation Date 28th September 2007

We also tried the Ouija board at the foot of the stairs with the board on a table adjacent to the stairs. During that experiment I was a spectator and had positioned myself on the furthest side of the table from the stairs and to its left as you face the stairs. Andy was videoing the experiment and was positioned to my left. As I looked around I thought I saw a small bright light move across the floor just inside the Lace Room about one metre inside the door and going from left to right. As I turned round to get a better look Andy chose that moment to step between me and the door so I lost sight of the light. By the time I was able to look again it was gone.

We tried the Ouija a final time in the Bedfordshire and Hertfordshire Regiment Gallery but again with no success. During that experiment I set my tape recorder running and left it there after the experiment.(1hr 3mins recording) marked by an (S) on the plan.

Vigil 1: Bedfordshire and Hertfordshire Regiment Gallery – 20:00 to 20:44

20:10 Leana smells chocolate which she could only smell between us. She had not smelt it as we entered the gallery or settled ourselves in for the vigil. On the plans at the end of this report the places we sat during the vigils are marked in the appropriate rooms by the symbols (L) and (B).

20:17 I saw a bright red dot that was either reflected in the glass of the cabinet in front of me or else was positioned high up on the top left corner of a beam that runs across the room from the far end of the corridor that goes to the disabled toilet. The spot was bright, very similar to that produced by the laser pointers in our torches or the laser indicator on my infra-red thermometer but it was none of those.

20:29 Leana was facing forward, looking just above her hands which were in her lap when she saw the light flicker on her hands as if something had walked in front of her going from right to left and casting a shadow. Where we were positioned the only source of light was at the other end of the room, in front of us, coming from a strip light in the corridor to the disabled toilet. This light did provide a considerable amount of illumination even at the far end of the room where we sat so that everything around us was clearly visible.

20:35 I saw a dull flash of light in the far top right corner of the display cabinet in front of me about 20cm from the top. This tall and square cabinet was just in front and to my left and just in front and to Leana's right from where we were sitting.

20:43 I heard a click coming from the corridor which runs from the far left corner of the room we were in and goes passed the stairs.

During the vigil the temperature remained at a fairly constant 22.5°C

Vigil 2: Archaeology Gallery (side room) – 20:55 to 21:47

We decided to position ourselves in the small side gallery of the Archaeology Gallery (the one which contains the example of a Saxon burial). Leana chose to sit in the far right corner of the room between display cabinets and I sat in the middle of the floor.

When Leana sat down she reported that she felt very cold, in fact the whole room felt cold. Measurement of temperature revealed +17.5°C in the middle of the room but only +15°C in the corner where Leana was sitting. There was also a distinct draught blowing across the room. Further along the same wall (towards the entrance to the room) the temperature was +16.5°C whilst directly opposite it was +17°C. Unfortunately this turned out to be just due to the structure of the building. The wall to the

INVESTIGATION REPORT – Team 3



Investigation Site Luton, Wardown Park Museum

Investigation Date 28th September 2007

right of the entrance is the wall shared by the gentleman's toilet which is a cold area hence the slightly lower +16.5°C. But the toilet stops before the end of the wall and the last part (the wall where Leana was sitting) is open to the air so the wall is a lot colder.

The draught was an interesting one as at first it appeared to be coming from the left hand doorway (as you face the doorways from inside the side room). Later I felt it on my face when I was turned away from the doors. At times the draught was so strong and cold that it gave me cold shivers.

As Leana sat in the corner she said that she had the feeling that she needed to lie down curled up.

21:09 I saw a large patch of white light on the barrier opposite the left-hand door which lasted for about half a second. The barrier is part of the central display area of the Archaeology Gallery and is angled away from the left-hand side of the left-hand door. Because of the angle no lights can shine on it from the entrance door to that gallery. In front of the barrier is a table on which were positioned a trigger object and motion detectors. Hanging from the barrier is a copy of a Saxon mirror (polished metal) but this was below where I saw the light.

21:13 Leana got the impression of a young girl, aged 5 to 6, with honey-blond hair tied up in a pony-tail which reached half-way down her back. She was lying where Leana was lying and in the same position. She had the thought that it was funny looking up at people going passed from such a low down position.

She picked up the name Amanda and said that whatever Amanda is wearing comes to about mid-calf and got the impression of the colour green. She said that she was seeing things from Amanda's point-of-view.

Amanda is not lying on the floor because she is scared or anything like that; it is just because she likes lying there.

21:22 I hear the sound of someone calling out.

Leana thinks that Amanda is at a party as there are a lot of people around. She also senses a little dog running around, small like a terrier but not pure-bred, a mongrel. It is not very old, only about six months to one year.

Everyone around is ignoring Amanda. Her parents are too busy entertaining to pay her any attention. At the time she (Amanda) thought they were in the kitchen. Her Nan is there, she likes her Nan. She is Amanda's paternal grandmother and she does not like wearing jewellery, just loads of bracelets.

Leana picks up on the name Pat which may be her dad's name (Patrick?). She also picked up that Amanda's Nan's name is Doris but she couldn't get Amanda's mother's name. Leana felt that Amanda's mother does not feature much in her life. She has no brothers or sisters but she does have two cousins who are slightly older than her, one is seven whilst the other is around eight to nine. Her cousins generally stay out of her way but they do like to tease her, fortunately they are not at the party.

Leana now felt that this was a Christmas party. The room Amanda is in is a small lounge with two sofas, on one of which her Nan is sitting. There are lots of people in the room but they don't step on her as they are used to her lying on the floor. She is lying in a corner with no furniture around her but there is a table a little way off. The sofas are on the opposite side of the room (where the Saxon burial display is); they are not up against the wall but pulled out slightly into the room. As Leana sees it the room goes further back than it does now opposite to the entrance doors. Leana feels that the doorways were there then but they were actually archways. The other side of the archways there is a table full of

INVESTIGATION REPORT – Team 3



Investigation Site Luton, Wardown Park Museum

Investigation Date 28th September 2007

food but Amanda does not want any as she is not hungry. Her mother has tried to get her to eat but she (Amanda) is stubborn.

Break Period

During a thirty minute break period Leana and I went for a tour around the upstairs.

22:10 Leana said that she could not breathe at the top of the stairs (which is why we chose that as our third vigil location). Marion, who was there with us at the time, reported the same effect in that area.

22:14 In the region where the EMF meter kept going off Leana reported that she felt very sick.

Just after the break a séance was held in the upper gallery where the bar is. During the séance I saw a bright red patch, about 2cm across on Steph's left elbow. At the time we were standing in an oval pattern holding hands. Andy was at one end with me on his left and Steph on his right.

Vigil 3: Top of Stairs – 22:30 to 23:15

At the start of this vigil we sat on seats at the top of the stairs looking into the stairwell.

22:45 Leana saw a bright patch of light over the door to the right of the top of the stairs (as you face the stairs). The light spanned the width of the door and went from the top of the door to the ceiling.

At 22:55 we relocated to the top of the stairs and sat on the top step.

23:02 I see a dark shadow cross the lower left-hand banister on the outside (bottom of the stairs, left as you face up the stairs). The shadow was not on top of the banister just the side and moving from left to right down the line of the stairs.

23:08 A lot noise is heard coming from downstairs (in the tea room due to non-LPS personnel).

Vigil 4: Lace Room – 23:28 to 23:33

I sat in the doorway to the room staring into the display cabinet where the reflection of a woman had been seen. Leana sat at the end of the central display, to my left. After a couple of minutes we decided that the vigil was a waste of time due to the noise coming from the tea room so we relocated.

Vigil 4a: Basement Corridor – 23:35 to 00:11

For this vigil we both sat at the end of the corridor where it is said the dead bodies were placed when the building was used as a hospital. We sat furthest away from the stairs by a door at the end of the corridor (two further doors on our right). With the lights off this area of the cellar was pitch black. The only light came from a fluorescent safety strip on top of a filling cabinet, this we moved round the corner out of sight. The only other light came from occasional flashes from an infra-red detector at the opposite end of the corridor.

23:50 I went for a walk along the corridor and had gone two paces when I saw a faint blue-white rectangle of light on the wall to my left. It was at shoulder height and measured about 10cm by 5cm. I also had a cold shiver across my shoulders. I told Leana to try the same location but she felt nothing. I walked the area again and got cold shivers in the same place even though I was walking in the opposite direction. Both times the lights were off and I couldn't tell where I was

INVESTIGATION REPORT – Team 3



Investigation Site Luton, Wardown Park Museum

Investigation Date 28th September 2007

but both times it was by the nearest edge of the second door on the right from where we were sitting.

00:02 I saw a line on the wall to my left (when sitting at the end of the corridor). It was about one metre in front, 75cm long and 8cm high in the centre (). It was bright enough to see straight on as I looked straight at it (not out of the corner of my eye).

00:07 I was talking about how weird my eyes had gone in the total darkness, a wave of light moving slowly upwards then repeating at regular interval (every few seconds). Leana said she heard a rustling noise. Just before and again just after this I saw a red patch on the far end of the left wall.

Vigil 5: Bar Area – 00:18 to 00:59

For this vigil we sat on a bench at the end of the corridor where the bar is positioned so the bar was on our right and we were facing the children's gallery. This meant that there was an entrance on our left and another, again on the left, 3m in front.

00:29 Leana hears the sounds of people arguing, she says she hears it in her mind as she can't locate it with her ears. All the voices are male and sound as if they are trying to make a point, not angry, raised but not shouting. She said it did not seem to be associated with the house as it definitely sounds as if it is coming from outside.

On one display there is a monitor screen beneath which is a fan which was constantly blowing. In the noise of it I could hear what sounded like a rugby crowd. I told Leana this and she said she may have been hearing the same thing.

00:38 I saw a red dot on the wall to the left of the bench, in the entranceway. Temperature +19°C.

00:43 I see a bright green dot about 5m away on our left. I thought at first it was on a display (another monitor or similar piece of equipment?) but on looking with my torch I found that it would have been in mid-air beneath a display as there was nothing solid in the area. The dot was very bright and I was looking straight at it.

00:54 Neither of us could hear the crowd any longer but the fan was still on, making the same noise and we had not changed positions.

Vigil 6: Archaeology Gallery – 01:10 to 01:44

Before we started this vigil we returned to the side gallery off the main Archaeology gallery to see if Leana could still pick up on Amanda but she said that the atmosphere was different and she was no longer there. Instead we decided to sit near the entrance door to the main part of the gallery facing down towards where the doors to the side gallery are (and where Leana said the food table was).

01:15 Leana says she feels cold, colder than anywhere else in the building yet the temperature is +19°C, 4°C warmer than the area she was lying in when she picked up on Amanda.

We then had an interesting experiment in coincidence or psi. I yawned but had turned my head away from Leana so she did not see me yawn in the dark and I made no noise, yet she yawned too. Two minutes later the same thing happened again, coincidence, psi or symbiosis?

01:24 Steph's motion detectors were in front of me and about 3m away. I could see the 'on' light reflected in the display cabinet 6m in front of me (beyond the detectors) and in the cabinet just in

INVESTIGATION REPORT – Team 3



Investigation Site Luton, Wardown Park Museum

Investigation Date 28th September 2007

front of me and to the right. Suddenly the light in front disappeared even though I was looking almost straight at it, whilst that to my right remained fully bright. At the same time Leana sensed a strong aroma of flowers and herbs.

01:41 I was looking at the red dot of Steph's motion detector in the cabinet at the far end of the room in front of me. I had not realised that a whole area around the dot had been glowing red until it suddenly went off and the area became black.

01:43 Leana reports nothing at the end of the vigil but a high pitched noise which is beginning to irritate her. I ask what noise and she said that it had been going on for 5 to 10 minutes. I could not hear it yet I can normally hear high pitched noises and have not yet found any natural one that someone else could hear but I couldn't.

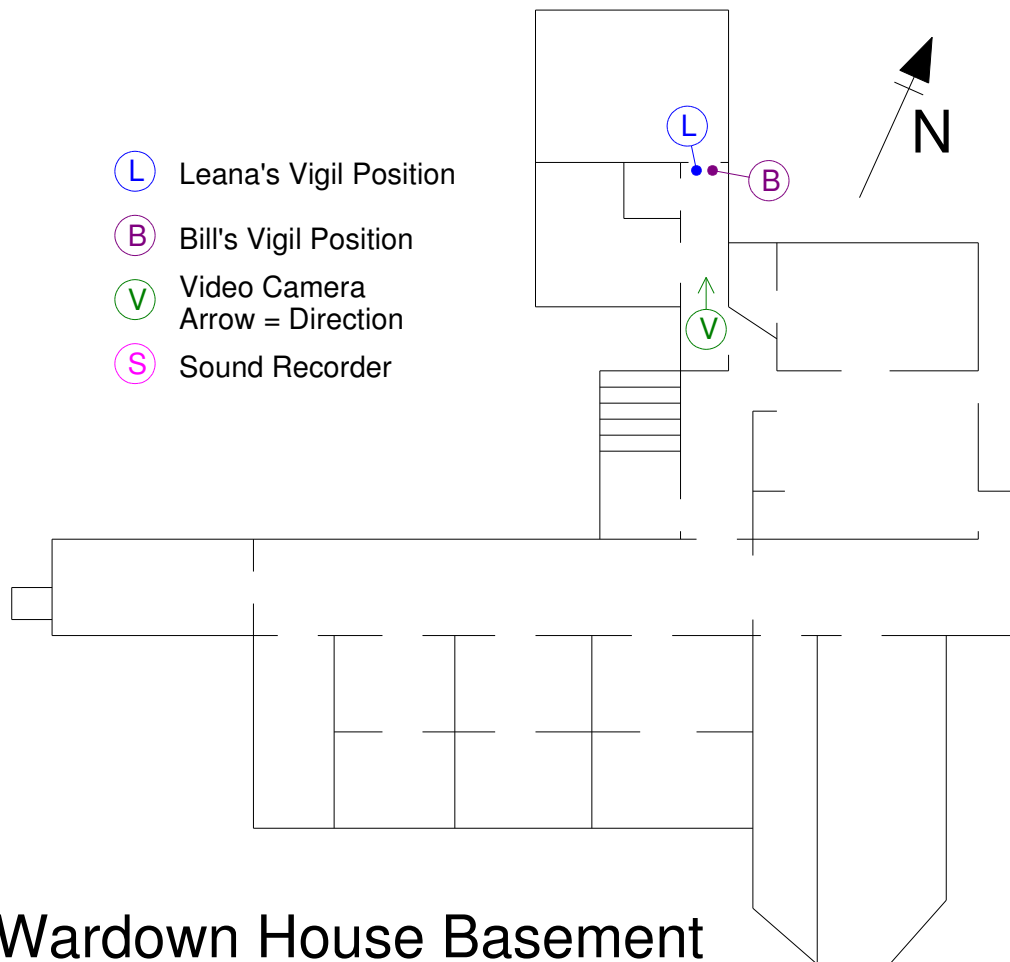

Wardown House Basement

INVESTIGATION REPORT – Team 3



Investigation Site Luton, Wardown Park Museum

Investigation Date 28th September 2007

