

INVESTIGATION REPORT – Team 1



Investigation Site	Bromham, St Owen and Segenhoe, All Saints
Investigation Date	27 th August 2010
Report By	Andy Fazekas
Team Members	Andy F, Elaine, Trevor

Bromham, St Owen

Pre-Investigation

- 20:45 Before the investigation started we had a walk around the churchyard to get an idea of the area and to check where the public footpaths lay.
- 21:10 Before we split into groups, Elaine said to Bill that it seemed to have gone cold around her hands.

Vigil 1: Churchyard to West – 21:15 to 21:50

For this vigil Andy is positioned in the southwest corner of the churchyard, Elaine is just west of the tower and Trevor is seated on a bench to the south of the tower. For the positions of the team members see the plan at the end of this section.

- 21:18 Elaine gets the name *Robert*.
- 21:20 Trevor takes an EMF Reading that shows 0.01mG.
- 21:27 Elaine gets the impression of a pilot's grave.
- 21:30 Trevor notes that he can hear general noises coming from the village nearby.
- 21:31 Andy notes that a car pulls up.
- 21:34 Andy takes an EMF reading that shows no EMF activity and a temperature reading that shows as +12.6°C.
Trevor takes an EMF Reading that shows 0.01mG.
- 21:40 Elaine sees a child standing between the two trees in front of her (*Editor's Note: where Bill sat for the next vigil*).
- 21:45 Trevor takes an EMF reading that shows 0.01mG
Andy notes that he feels pain on the back of his head.
Andy observes a car coming up the pathway to the church. The car pulls up on the other side of the wall to Andy and he observes that there are four young women inside who sit there smoking oblivious to the fact that Andy is on the other side of the wall.
- 21:50 Trevor takes an EMF Reading that shows no hits.
Bill announces that the vigil has ended over the radio Andy is using, this is heard by the girls in the car and when Andy stands up, the girls in the car quickly drive off.

Pre-Vigil

- 22:06 Andy observes a shadow figure shaped like someone wearing a cape go from the wall next to the lane towards the main church entrance very quickly.

INVESTIGATION REPORT – Team 1



Investigation Site Bromham, St Owen and Segenhoe, All Saints

Investigation Date 27th August 2010

Elaine gets the name *Catherine*.

Vigil 2: Churchyard to East – 22:10 to 22:40

For the positions of the team members see the plan at the end of this section.

22:10 Andy takes an EMF reading that shows no activity. Andy also takes a temperature reading that reads as +12.6°C.

22:12 Elaine gets 'We all fall down'.

22:15 Andy takes a temperature reading that shows +13.8°C.

Andy takes an EMF reading that shows no EMF activity.

Trevor takes an EMF Reading that shows 0.01mG.

22:19 Elaine hears footsteps on gravel but could not see anyone.

22:25 Elaine has the feeling of wanting to be sick.

Trevor takes an EMF Reading that shows 0.01mG.

22:28 Elaine hears rustling noises to her right.

22:31 As Elaine was looking towards the church she saw flashes of light in the stained glass.

22:33 Elaine sees what she thought was smoke above the trees. (At the end of the vigil, back at the cars, it was found to be strobe lighting.)

22:40 Trevor takes an EMF Reading that shows 0.01mG.

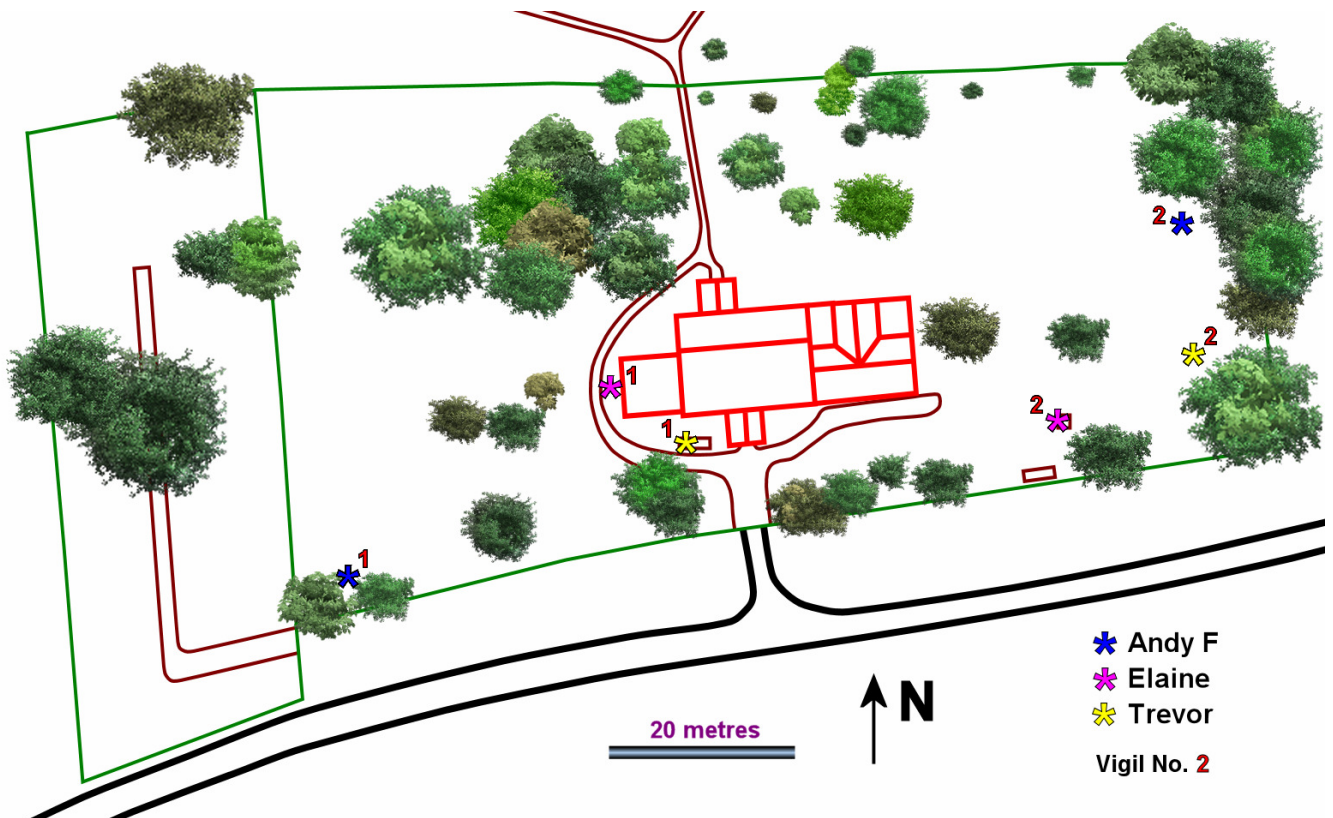

INVESTIGATION REPORT – Team 1



Investigation Site Bromham, St Owen and Segenhoe, All Saints

Investigation Date 27th August 2010

Post-Vigil

Andy asked Bill if any of his team were in the area where Andy had seen the shadow person. Bill informs Andy that he is not aware of this however times need to be clarified as Andy is unsure of the time he observed this without listening to his tape recorded notes (*Editor's Note: At the time Team 2 were setting up to the west of the church and no one went near the entrance. Bill can confirm this as he could see the entrance from where he sat*).

Post-Investigation

There is no recorded paranormal activity on Team 1 equipment.

Segenhoe, All Saints

Vigil 1: Churchyard to South – 00:10 to 00:40

For the positions of the team members see the plan at the end of this section.

00:10 Andy takes an EMF reading that shows no EMF spikes. Temperature reading is +5.6°C.

00:15 Trevor takes an EMF reading of 0.01mG.

00:16 Elaine has the impression of a young girl wearing a white dress with flowers in her hair dancing around a maypole.

00:20 Andy changes his disc in his camcorder.

00:22 Elaine gets the name *Anna*.

00:25 Trevor takes an EMF reading of 0.01mG.

Andy takes an EMF reading that shows no EMF spikes.

00:28 Elaine see a child standing by the gate at the other side of the church.

00:35 Trevor notices a thin misty shape moving to his left.

00:36 Trevor takes EMF readings pointed at the disappearing mist and gets variable results.

00:40 Trevor is still looking for the mist when Andy calls the vigil to a close.

Vigil 1: Inside Church – 00:50 to 01:20

For the positions of the team members see the plan at the end of this section.

00:43 Elaine sees an old lady wearing a red bonnet and black coat standing next to the church entrance.

00:45 Andy takes an EMF reading that shows no EMF spikes. Temperature reading is +12.4°C.

00:48 As Elaine was looking to the church window the top of someone's head could be seen going past.

00:50 Andy takes an EMF reading that shows no EMF spikes.

00:53 Elaine gets the name *Charles*.

00:55 Trevor takes an EMF reading of 0.01mG.

INVESTIGATION REPORT – Team 1



Investigation Site Bromham, St Owen and Segenhoe, All Saints

Investigation Date 27th August 2010

00:56 Andy takes an EMF reading that shows no EMF spikes.

00:56 Elaine gets the impression of a man lying next to a grave stone.

01:03 Elaine hears church bells ringing in the distance.

01:05 Andy takes an EMF reading that shows no EMF spikes. Temperature reading is +11.8°C.

01:15 Trevor takes an EMF reading of 0.01mG.

Post-Investigation

01:30 Bill pointed out to Trevor some of the odd things about the church, windows, pillars etc.

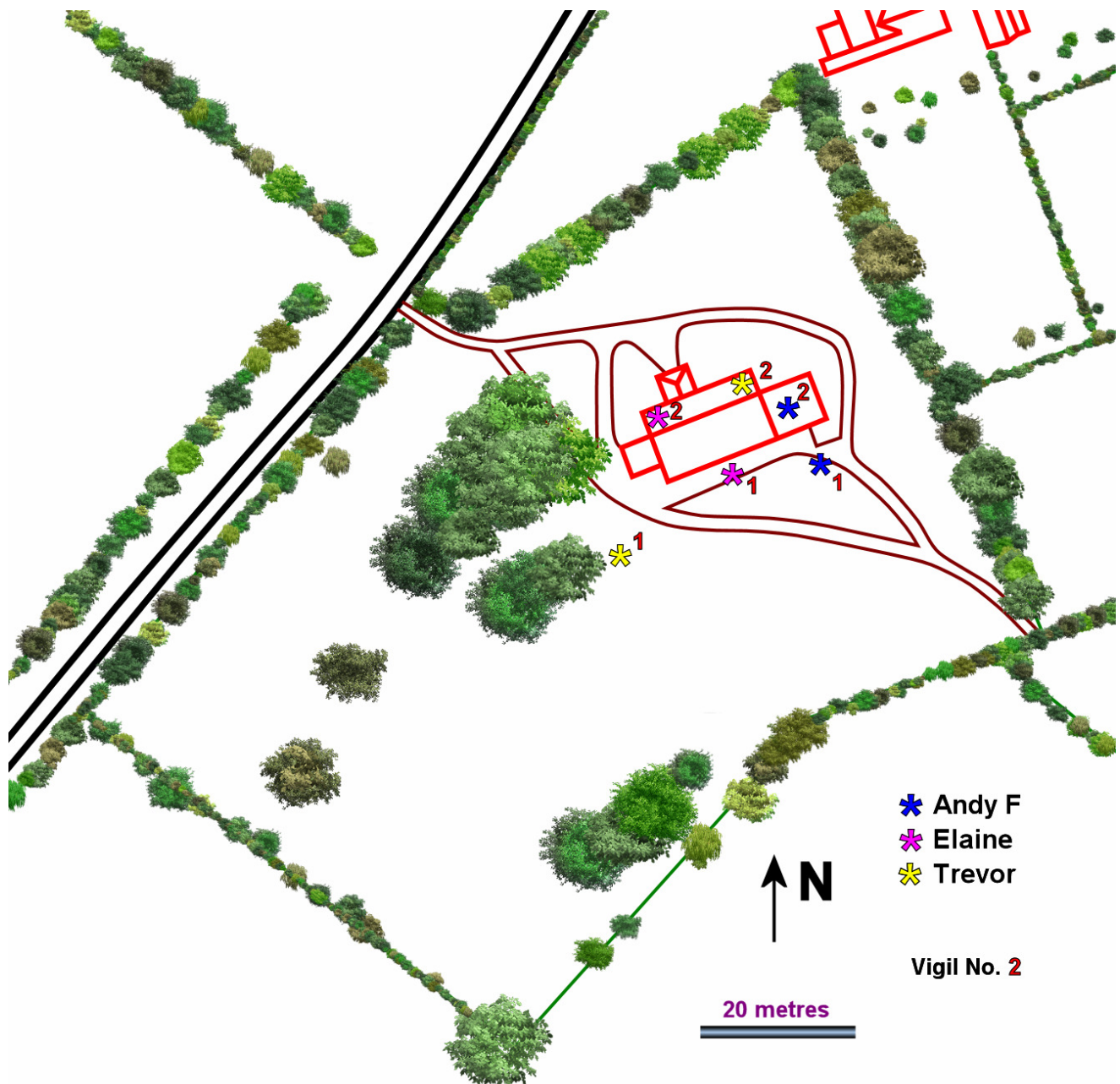

INVESTIGATION REPORT – Team 1



Investigation Site Bromham, St Owen and Segenhoe, All Saints

Investigation Date 27th August 2010

Equipment List

Andy Digital Camera: Panasonic Lumix DMC-FS15
 Digital Camcorder: Sony DCR-DVD306E
 Digital Voice Recorder: Olympus VN-480PC
 Dictaphone: Sanyo TRC-525M
 EMF meter: K-II
 Digital Infrared Thermometer: IR-102
 Digital Compass/Altimeter/Thermometer: WS110
 Laser Matrix Pen
 Pen, torch and watch

Elaine Digital Camera: Kodak C913
 Digital Voice Recorder: VN-2100PC
 Notepad & pen, torch and watch

Trevor Digital Camera: Kodak Easyshare C713
 Digital Voice Recorder: Olympus VN-3500PC
 EMF Detector: Lutron 822A
 EMF meter: K-II
 Notepad & pen, torch and watch