

INVESTIGATION REPORT – Team 2



Investigation Site	Riseley
Investigation Date	26 th November 2010
Report By	Bill King
Team Members	Bill, Steph, Dee, Sarah

Pre-Investigation

The team met in Church Lane and decided to separate into three teams to cover the three investigation sites as there were too many people to all visit the sites at the same time. This allowed us to have two teams of four and one of five.

As the teams were heading off to their initial sites Team 2 were heading to Bill's car when his radio crackled which usually only happens when a taxi is nearby (the taxi's radio interferes with the LPS radio) but there were no visible taxi's.

General

The night was a cold one with virtually clear skies and no wind. The whole of the Riseley area is a generally quiet one as there are no major roads nearby and Riseley is a quiet village.

Tom Knocker's Pond

Background

The area around the pond is alleged to be haunted by the spirit of someone who drowned there many years ago. It is said that the site is where Tom Knocker fell from his horse, when returning from the pub, and was drowned.

General

This site was a dark one as there were no street lights nearby as the site was in an isolated area just off the road between Riseley and Bletsoe. When we first arrived the waning moon (70% visible) was just rising above the horizon (over Thurleigh airfield). The only real noise was coming from the adjoining road with a car going by every few minutes. The only other noise was that from distant traffic to the south-southwest. The night was a cold one with a virtually clear sky and no wind.

The pond is now empty of water except for the very bottom which was damp. The slopes of the pond are now covered in trees and with some undergrowth though the area was generally very clear due to the time of year. The original area of the pond is very well defined as there is still a distinct hollow in the ground bordered on the west by the road to Riseley and the north by the track to Park Farm

Vigil: 21:27 to 22:05

For this vigil the team spread themselves around the pond. As the pond is now empty of water we actually positioned ourselves where the water would originally have been. For a plan of the site see the drawing on the next page.

Dee positioned herself on a chair near the bottom of the area of the pond, which was marshy, but with no water present. She had her back to the main road against a small tree and ensured that no branches or twigs were touching her (she asked Bill to check that this was the case). She had no prior knowledge of the area or any known reports of a haunting. She sensed nothing much at the outset of the vigil. She placed her DVR on the ground a metre away.

21:27 Bill measures the temperature at -7°C on the leaf-litter and -4°C on the trees.

INVESTIGATION REPORT – Team 2



Investigation Site

Riseley

Investigation Date

26th November 2010

At this point the moon was just visible rising to the east by south.

21:30 Dee tries to relax despite the distracting sounds of passing traffic etc.

When the vigil began Sarah could hear lots of little scurries across the frozen leaves. Sarah saw a small rodent like a mouse or a vole.

Whilst settling, Sarah made a noise falling off her chair.

The sound of running water could be heard to Sarah's left and down to the bottom of the currently empty pond.

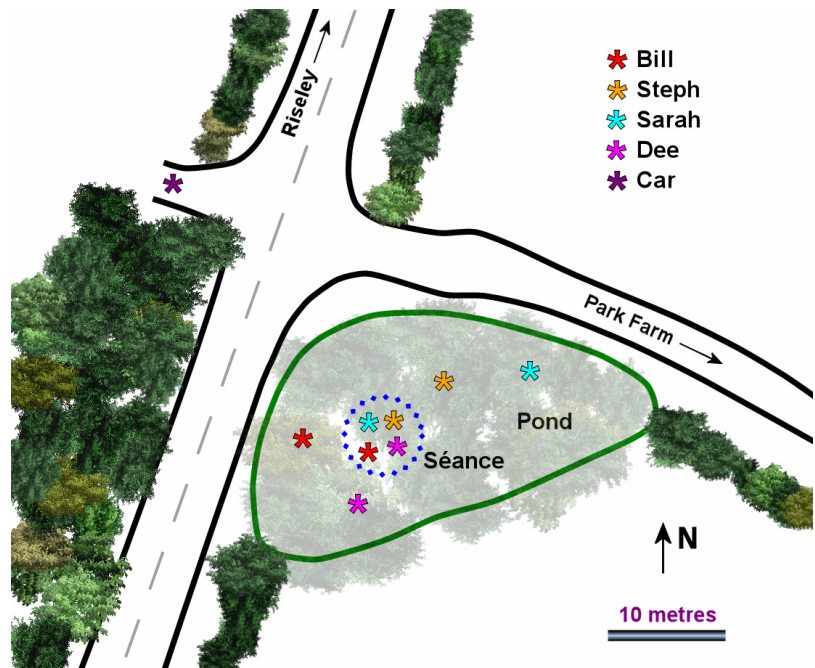

21.36 Dee asks the others if they can hear running water. They can and Sarah also remarks that there are “small mice” moving around (she had seen them).

21:37 As Steph is looking around she sees a black figure standing half-way between her and Bill. The figure is quite large and stocky.

21:38 Bill leaves his sound recorder on the ground 0.5 metres away from him towards the track to Park Farm.

21.43 Dee gets a sudden ‘clear’ impression of someone hiding something – a weapon and money – nearby.

21.44 Sarah received a phone call, which she turned off.

21.45 Dee gets a faint impression of drowning – accidental and unrelated to the ‘hidden stuff’ mentioned earlier. Dee also hears movement in the undergrowth around her.

21:46 Bill notes the sound of something walking through the leaf-litter to his right (the south-southwest) and behind Dee who was facing roughly east.

Steph hears a noise in the leaves to her right (near to Bill's right). Steph sees Bill shine his torch in the area but she cannot see anything.

The names *Simon*, *John* and *The Smith* come suddenly to Dee's mind.

21:47 The sound Bill heard at 21:46 was now moving along the hedgerow to the south of him and was now to Dee's right and moving towards her.

Dee notices the beam of her mini keyring torch (that she uses for note taking) is flickering. It had never done that before. Dee also hears movement behind her and is convinced that it sounds like proper footsteps. She presumes it is an animal, but is spooked nonetheless by the sound's proximity and uncanny resemblance to human footsteps.

INVESTIGATION REPORT – Team 2



Investigation Site

Riseley

Investigation Date

26th November 2010

Whilst Sarah was composing herself, she turned to her right and fleetingly saw a tall man in grey standing next to her, before a small tree. Looking again, he had gone.

21.50 Dee suddenly hears “I wanted glasses too”.

21:51 A black shadow is seen by Bill about two metres in front of Dee (further along the base of the pond). It appeared as depicted on the right emanating from a dark area (the hedgerow to the south of the pond area) so that Bill could not see the top of the shadow.

21.53 Once again, Dee gets the very strong impression of money and a weapon (possibly a knife) having been hidden nearby (in a leather or ‘oilskin bag’).

21.54 Dee hears “Children played here a lot – boys. One broke his arm falling from a tree up the lane.”

21:55 Bill hears a sound like a quiet male voice coming from the west-southwest. He had heard it several times earlier on but could not make up his mind what it was. This time there were no other noises so he could hear it clearly.

21.57 Dee gets the impression that ‘someone’ is fascinated with her glasses.

21:58 Bill hears a sound like something moving behind Steph (closer to the far track). Sarah seemed to hear it as well as she shone her torch into the area where Bill thought the sound had come from, in the undergrowth on our side of the farm track.

Dee hears “Missing from church” and is almost immediately unnerved by what sounded like footsteps to her right and behind her.

22:00 Sarah heard a loud crack like a footstep.

Sarah had a feeling of eyes watching.

22:01 Steph hears what sounds like whispering coming from in front of her and areas around Dee and Bill. It’s almost like two people talking back and forth.

22:02 Bill hears a sound which at first seemed like a voice but was actually more like trickling water coming from the southwest by south. The area in which Dee was sitting was right at the bottom of the ditch and she reported that the soil was moist so there was water around. The Ordnance Survey map shows a water course the other side of the road heading southwest so the noise could have been coming from there. It should be noted that this sound, like a human voice, came from behind and to Bill’s right whereas the other voice he had been hearing come from directly behind him (a difference in bearing of just over 30°).

Dee is still hearing ‘footsteps’ behind her.

22:04 Bill measures the temperature at -10°C on the leaf-litter and -7°C on the trees.

Séance

After the vigil it was decided to try a séance in an open area within the pond. The team stood in a circle with Dee’s sound recorder in the centre of the circle and Bill’s in an open pocket on his tool jacket. For the positions of the team members see the plan on the previous page.

INVESTIGATION REPORT – Team 2



Investigation Site	Riseley
Investigation Date	26th November 2010

Dee did not make any written notes during the séance, but the following comments were taken from her DVR recording (annotated with approximate time equivalents). Dee placed her DVR on the ground in the centre of the séance circle.

22.10 Dee remarks on a distant voice-like sound. It turns out to be a bird.

22.11 Dee suddenly feels pressure on the back of her right knee, which causes it to momentarily 'collapse'. She had been standing still with both knees 'locked' prior to the incident. A few seconds later Dee's knee felt hot. Then the 'heat' moved suddenly down the leg. Bill measured the ambient temperature and could not find reliable evidence of a significant temperature difference around Dee's knee and lower leg that would corroborate the sensation she was experiencing ("a warm patch").

During the séance Dee reported that her right knee was feeling hot so Bill used his infrared thermometer to measure the temperature of her knees both of which came out between +4.5 and +6°C). She then reported that the heat had moved to the back of her knee but temperature checking again revealed no real difference between the joints.

22.15 There is a loud 'snap' or 'crack' under Steph's foot as though she had stepped on a branch. However, Steph had been standing still and the ground was too soggy for what sounded like a dry snap. Dee's DVR picked up this sound clearly.

22.16 When Bill began asking out for a "more positive sign" of a presence, Dee hears definite movement/footsteps.

22.19 More movement is remarked upon.

22.20 Dee and Bill both react simultaneously to a loud sound of movement/footsteps directly behind them. Despite their immediate reaction, no evidence of small animals/movement on the ground can be seen, even though the sound had been right behind them and the nearest undergrowth was at least some 1.2 metres away.

Post-Vigil

As we made our way back to the car, Dee and Sarah were talking near the hedge next to the road, when a loud 'whaaah!' in a male voice was heard right next to them - Dee carried on thinking it was Sarah, and Sarah asked Dee if it was her! Sarah does believe this was very unusual as it was not a noise normally heard or even made by members. There were no cars and Bill and Steph were over the other side of the road by the car. They did not hear it. Sarah and Dee both heard this noise.

Church Lane

Background

In the late 1970s a local family were walking down Church Lane towards All Saints church late at night. As they looked towards the church they saw that it was in ruins and they could see straight through to the altar. The church is still not in ruins.

General

The night remained clear and cold with no wind. This area was a quiet one despite the church being close to the centre of Riseley, a large village.

INVESTIGATION REPORT – Team 2



Investigation Site

Riseley

Investigation Date

26th November 2010

Walk

As the haunting occurred when people were walking down Church Lane towards the church it was decided to start the investigation by doing the same. We started at 22:44 and walked the one hundred and eighty metres from where we had parked to the church gates. For details of the area see the plan on the right.

Once at the church we generally walked around the churchyard meeting up again at the east gate of the churchyard. After spending a few minutes near the gate we continued our walks around the church meeting up again at the Church Lane entrance.

Dee made no written notes but did use her DVR to record most of this part of the investigation.

22.44 Dee switched on her voice recorder at the start of the investigation.

22.45 Dee is surprised to hear what sounds to her like 'walking on a summer day' – birds chirping etc. None of the other team members heard anything.

22.47 Dee remarks that the hedge on the left at the top of the lane near the church looks like something from the movie, Edward Scissorhands!

22.48 As Dee walks up the path towards the entrance of the church (within the churchyard) she notices that the angle and lighting give the illusion that the church has no roof and that one can see straight through it: "It looks like a shell".

22:49 As Steph reaches the gates to the church her right wrist starts to hurt. This continues until she walks through the gates then it instantly stops.

Dee continued to walk around the churchyard but 'felt' or 'heard' nothing of significance.

23:10 While Bill and Steph were taking photographs of the church from beyond the east gate Bill heard a strange click to the right of the gate (north).

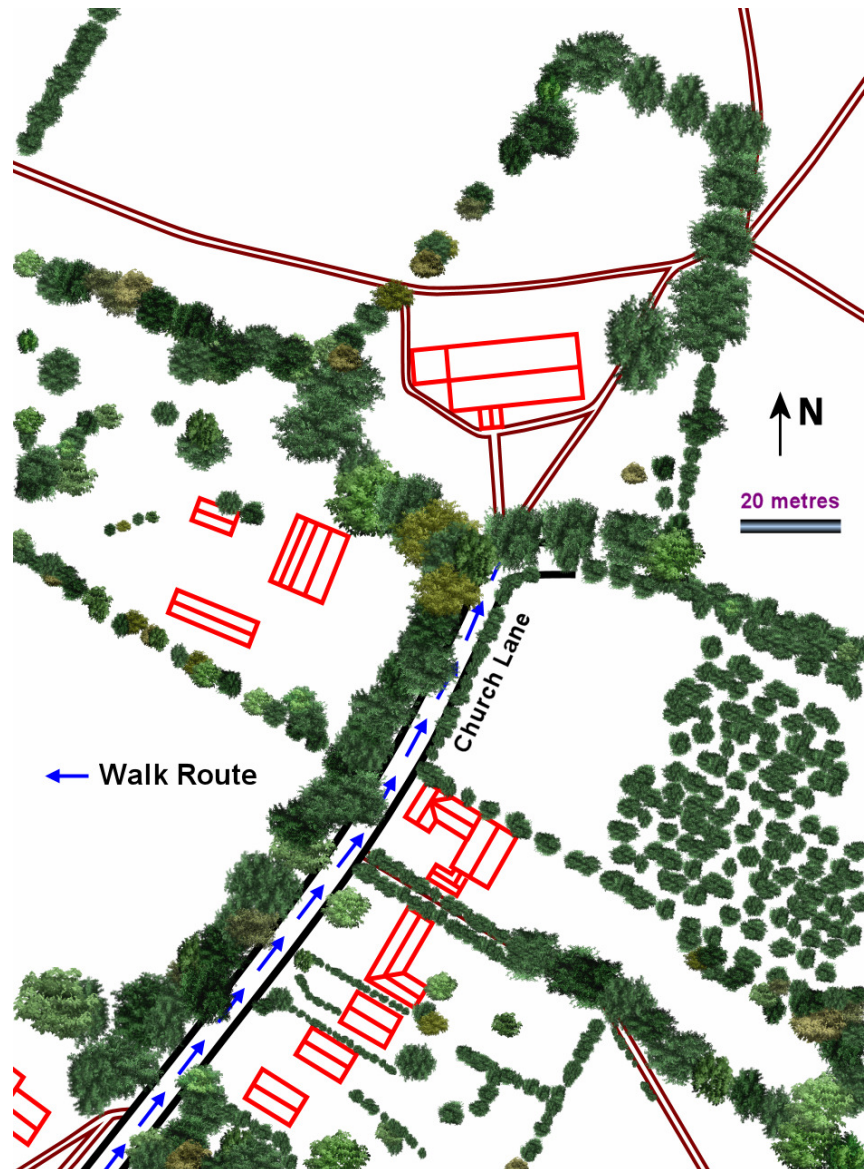

INVESTIGATION REPORT – Team 2



Investigation Site

Riseley

Investigation Date

26th November 2010

23:16 Bill and Steph meet by the west exit from the churchyard (northwest of the tower). Steph tells Bill that she feels that the churchyard is a lot colder than the Tom Knocker's pond site. Bill measures the temperature at -8 to -9°C so there wasn't a major difference between the two sites, at most just a couple of degrees..

23:18 Bill and Steph walk together counterclockwise around the church towards the south porch. Steph was about two metres in front of Bill as he approached the southwest corner of the south aisle. As Bill passed the tall west window of the aisle he saw that the right-hand third of the window was brightly lit (the window was divided into three by two mullions). At first it did not strike him as unusual then he realised the colour was wrong. At the time the lights above the south porch, in the south porch and near the gate to Church Lane were on (triggered by a passive infrared detector) flooding the area in orange-yellow light but the west window, as seen by Bill, was lit by a blue-white light. Bill went back to the window and found that the light was no longer visible. The light was like moonlight (similar in colour to the thin clouds that at the time could be seen in the sky below the moon).

22:22 Bill walked up to the Church Lane gate and told Dee what he had seen, then they both went to the window to investigate. Looking in through the window revealed that the west part of the south aisle was divided from the east end by a wall, an extension of the porch, so that the moon could not shine directly on the west window. A plan of the area is given on the right. There was a nave pillar visible through the window but there was no moonlight on it, in fact no moonlight was visible through the window. Checking the window with and without the lights on showed that the section of window was never illuminated. From where Bill was standing when he saw the light, reflections would have been impossible as any light would have had to have been on the south wall of the tower (in front and to the right of the window). In addition there were no lights that could be seen from the window except a pale white one (like a window) in the area of the old vicarage to the southwest (the other side of Bill to the window) which could not have caused a reflection in the window.

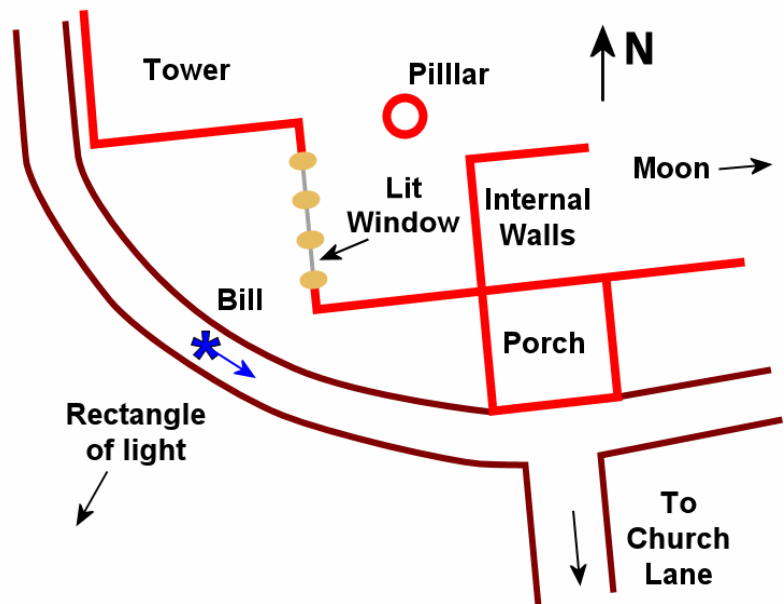

Sarah did not pick up on anything on this vigil probably due to the extreme cold, but Sarah did take some photos which might have something unusual on. She will be sending them on to Bill.

Post-Walk

As the team were walking back to the car down Church Lane Bill's radio crackles again. He tried to contact the other teams but there was no response.

INVESTIGATION REPORT – Team 2



Investigation Site

Riseley

Investigation Date

26th November 2010

Eastfields Corner

Background

Ken Surridge, of Buryfields Farm, was travelling along the road to Dean when he became aware of a sound like a horse. It appeared to plunge through the hedgerow and cross the road from one side to the other. In all the time he heard the sounds nothing was visible. There were two other witnesses present at the time and all three said that they felt the cold air as it passed.

General

The night remained clear and cold with no wind. This area was a very quiet one and normally a dark one as there are very few habitations nearby. The area was moderately well lit by the moon giving areas of deep shadow. The only noises were from occasional cars passing along the road to Upper Dean to the north and northwest eight hundred metres away. During the time we were on site only a few cars passed by.

Pre-Vigil

Approaching the location in Bill and Steph's car, Dee got the strong impression that the area was actually quite busy (in traffic terms) in past times – not at all like it is today.

23:45 Bill measure the temperature on the road at -7°C.

23:47 Just after the team reached the site Bill's radio again crackled. He tried radioing the other teams but did not get a response. He then noticed that the radio was set to channel 2 instead of the normal channel 5. When Bill had set the time on the radio (a couple of hours before the investigation) the channel had been correct. To change channel requires the Menu button to be pressed for four seconds to unlock the keypad then it has to be released and pressed again followed by the Up control being pressed five times to change to channel 2. As the keypad was locked when Bill noticed the channel was wrong the Menu button would again have to have been pressed for four seconds to re-lock the keypad after the channel had been changed. All told this is a very unlikely sequence of events to have happened to get the radio to channel 2 and it had never happened before in the two years or more that Bill had had the radios (2 of the)m.

23:56 As Steph is walking down Swineshead Road she sees what looks like two figures walking up the road towards her about two hundred metres away. As she watches they seem to fade away.

Vigil: 23:55 to 00:30

For this vigil Dee sat on the east side of the junction whilst Bill sat on the west (see the plan on the next page). Steph and Sarah decided that it was too cold to sit at such an exposed site and decided instead to quietly wander around the area.

Dee positioned herself on a chair at the crossroads opposite the track leading to Eastfields Farm (which would have been the track that Ken Surridge would have been following to get to Dean). She faced towards the centre of the crossroads and placed her DVR on the ground approximately one metre away to her left.

00.00 Various distant church bells ring out midnight.

00.03 Once again, Dee is filled with the impression that this area was quite busy once upon a time, carts, people etc.

INVESTIGATION REPORT – Team 2



Investigation Site

Riseley

Investigation Date

26th November 2010



00:05 Bill measures the temperature as -7.5 to -8°C on the road and -9 to -10°C on the grass verge.

Dee notes that a car approaches.

00:07 Dee hears a 'feet on gravel' sound a metre or so away but cannot pinpoint the source.

00:10 Steph is standing in the middle of the crossroads looking down the road to Eastfields Farm. She sees a small white flash of light roughly fifty metres on the left side of the path that seemed to be on the hedgerow. She walks down to see if there was anything there to have caused the light but on reaching the area there is only a sparse hedgerow and tree saplings.

Dee 'hears' many WWII planes (bombers) flying overhead and 'hears' the words "Americans" "couriers", "coaches" and "messages".

00:11 Dee notes that another car approaches.

00:13 Dee notes the sound of distant dogs barking.

00:15 A breeze picks up and it is very, very cold. Dee is aware that she is finding it difficult to concentrate due to being distracted by the pain in her frozen feet!

00:17 Dee notes that another car approaches from a distance.

00:20 Dee has to stop due to being excessively cold.

During this part of the investigation Sarah did not pick up on anything unusual.

INVESTIGATION REPORT – Team 2



Investigation Site	Riseley
Investigation Date	26th November 2010

Post-Investigation

Tom Knocker's Pond: Nothing unusual is picked up by Dee's Digital Voice Recorder, there are no anomalies in any of Dee's digital photographs at this location.

Church Lane: Nothing unusual is picked up by Dee's Digital Voice Recorder, there are no anomalies in any of Dee's digital photographs at this location.

Eastfields Corner: Nothing unusual is picked up by Dee's Digital Voice Recorder.

Equipment List

Bill	Digital Camera: General Electric E1480W Digital Voice Recorder: Olympus WS-560M EMF Detector: Hutech Digital Infrared Thermometer: CHY 110 Digital Compass/Altimeter/Thermometer: WS110 Notepad & pen, torch and watch
Steph	Digital Camera: Samsung PL81 Gauss Meter Digital Infrared Thermometer: Tecpel DIT-512 Notepad & pen, torch and watch
Dee	Digital Camera: Fuji FinePix F31fd Digital Voice Recorder: Olympus VN-5500PC Notepad & pen, torch and watch
Sarah	Digital Camera: Sony DSC-H50 Compass Notepad & pen, torch and watch